

# Thermometer

Type 740, 750 och 760  
straight design

E 10.22.01

Ed.21.01

<b>Design</b>	Machine glass thermometer in straight design complete with thermowell of brass.
<b>Type</b>	<b>740</b> = case 110x36 mm <b>750</b> = case 150x36 mm <b>760</b> = case 200x36 mm
<b>Case</b>	Brass coloured aluminium screw for mounting of thermowell
<b>Temperature element</b>	Blue liquid filling
<b>Location of stem</b>	Radial bottom stem
<b>Thermowell</b>	Thermowell of brass with screw groove. Outside Ø10 mm with thread G1/2" Max pressure rate 16 bar
<b>Immersion length</b>	L = 40, 50, 63, 100, 160, 175, 200, 250, 300 mm
<b>Stainless steel</b>	Thermowell of stainless steel
<b>Weld-in thermowell</b>	The thermometer can be delivered with thermowell for welding Form D acc. to type D1, D2, D4 or D5. See datasheet E10.23.01

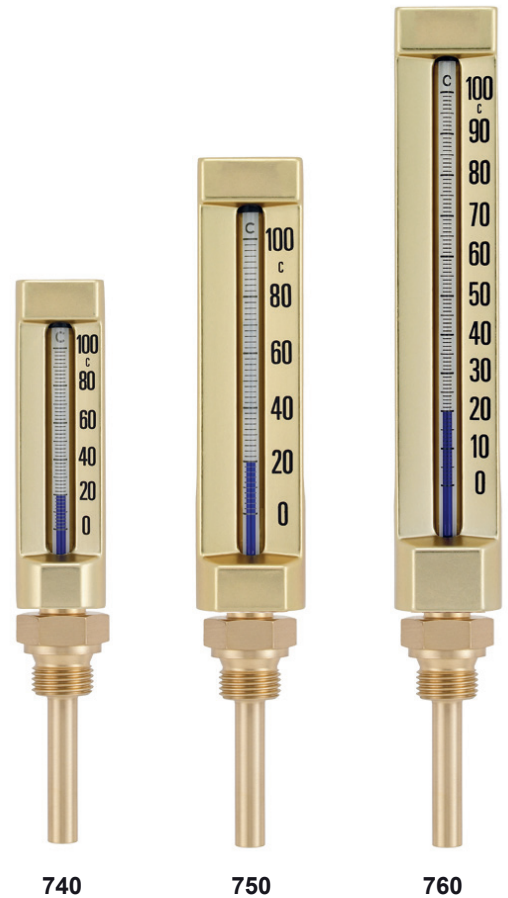

Scale range	Error limit	Scale spacing
-30+50°C	2,0%	1°C
0+60°C	1,5%	1°C
0+120°C	2,0%	2°C
0+160°C	4,0%	2°C
0+200°C	4,0%	2°C

Type 740 has error limit 5% in range 0+200°C  
Type 740 has scale spacing 4°C in range 0+160°C and 5°C in range 0+200°C

## Options extras



**Thermowell TW50-J**  
Solid machined type  
stainless steel  
Page 4



**Thermowell TW45-G**  
fabricated type  
stainless steel  
Page 4



**Thermowell TW45-GS**  
fabricated type  
screw groove - stainless steel  
Page 4



**Weld-in type D**  
for welding  
steel, stainless, 13CrMo44  
See datasheet E10.23.01

# Thermometer

Type 740, 750 och 760

straight design

E 10.22.01

Code number for thermometer - Thermowell of brass Ø 10 mm - thread G1/2"

Range	Length L	type 740	type 750	type 760
<b>-30 + 50°C</b>	63 mm	0740 4606	0750 4606	0760 4606
	100 mm	0740 4610	-	0760 4610
	160 mm	-	-	0760 4615
<b>0 + 60°C</b>	40 mm	0740 0203	-	0760 0203
	63 mm	0740 0206	-	0760 0206
	100 mm	0740 0210	-	0760 0210
<b>0 + 120°C</b>	40 mm	0740 0403	-	-
	63 mm	0740 0406	0750 0406	0760 0406
	100 mm	0740 0410	0750 0410	0760 0410
	160 mm	0740 0415	-	0760 0415
	175 mm	-	-	0760 0417
	200 mm	-	-	0760 0418
	250 mm	-	-	0760 0419
	300 mm	-	-	0760 0421
<b>0 + 160°C</b>	63 mm	0740 0706	0750 0706	0760 0706
	100 mm	-	-	0760 0710
	160 mm	-	-	0760 0715
	175 mm	-	-	0760 0717
	200 mm	-	-	0760 0718
	250 mm	-	-	0760 0719
<b>0 + 200°C</b>	63 mm	-	-	0760 0806
	100 mm	-	-	0760 0810
	160 mm	-	-	0760 0815
	175 mm	-	-	0760 0817
	200 mm	-	-	0760 0818
	250 mm	-	-	0760 0819
	300 mm	-	-	0760 0821



# Thermometer

Type 740, 750 och 760  
straight design

E 10.22.01

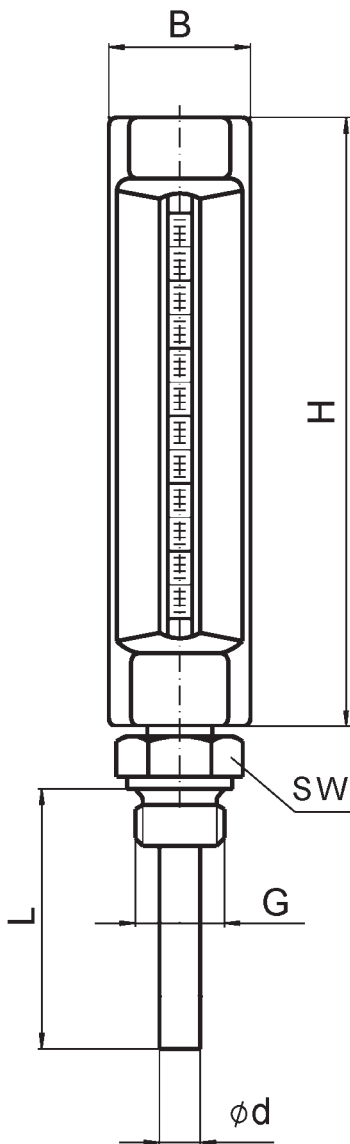

## Standard type

Brass coloured plastic or aluminium  
Thermowell of brass with screw groove



Plastic case or aluminium

Screw for mounting of thermowell



Connection with screw groove

## Option extra

Brass coloured aluminium  
Thermowell of brass with upper tread M18x1,5



Metal case

Female thread M18x1,5



Male thread M18x1,5

Type	H	B	Ø d	G	SW	Immersion length L
740	110	36	10	G1/2"	27	40, 50, 63, 100 or 160 mm
750	150	36	10	G1/2"	27	40, 63, 100 or 160 mm
760	200	36	10	G1/2"	27	40, 50, 63, 100, 160, 175, 200, 250 or 300 mm

# Thermometer

Type 740, 750 och 760  
straight design

E 10.22.01

## Thermowell in stainless steel as option extra

### Thermowell with screw groove

For direct mounting without adapter

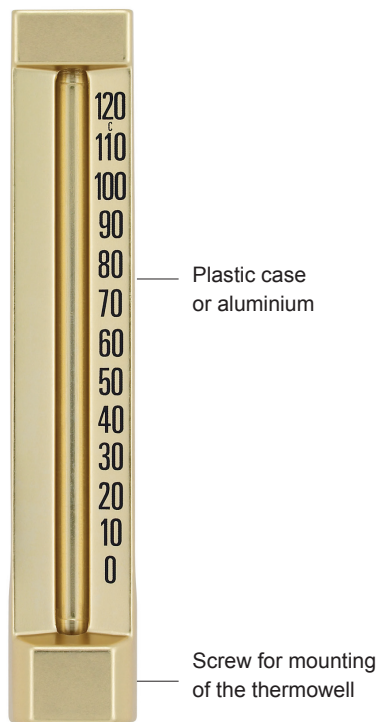

### Thermowell with upper connection M18x1,5

Must be completed with adapter 75520900 of brass with screw groove for mounting in the case

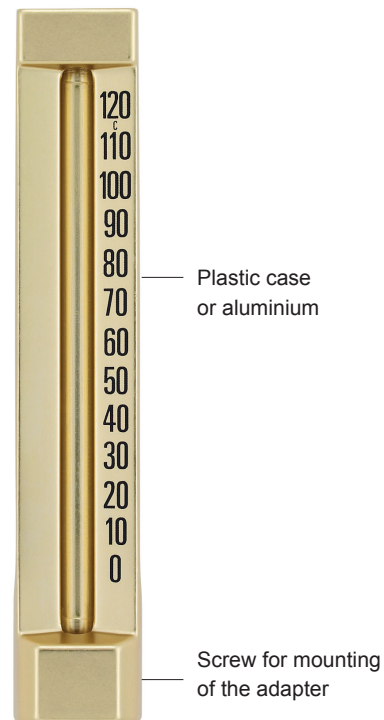

# Thermometer

Type 740, 750 och 760

straight design

E 10.22.01

## Thermowell in stainless steel as option extra



### Thermowell type TW45-GS

Thermowell in stainless steel 1.4571 or SS2348  
Fabricated type Ø10 mm - see datasheet E11.02.04  
With screw groove for direct mounting

Length	Male	Code
40 mm	G1/2"	71700603
63 mm	G1/2"	71700606
100 mm	G1/2"	71700610

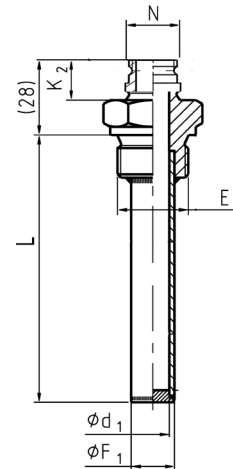

### Thermowell type TW45-G

Thermowell in stainless steel 1.4571 or SS2348  
Fabricated type Ø10 mm - see datasheet E11.02.02  
With adapter 75520900 of brass with screw groove

Length	Male	Code
63 mm	G1/2"	71700806
100 mm	G1/2"	71700810
160 mm	G1/2"	71700815
200 mm	G1/2"	71700818

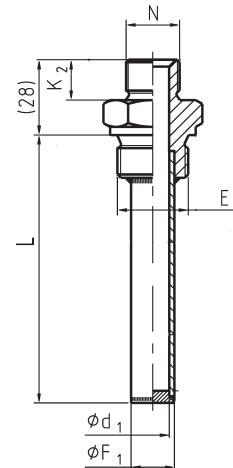

### Thermowell type TW50-J

Thermowell in stainless steel 1.4571  
Solid machined type Ø14 mm - see datasheet E11.02.01  
With adapter 75520900 of brass with screw groove

Length	Male	Code
40 mm	G1/2"	70700803
50 mm	G1/2"	70700804
63 mm	G1/2"	70700806
100 mm	G1/2"	70700810
160 mm	G1/2"	70700815

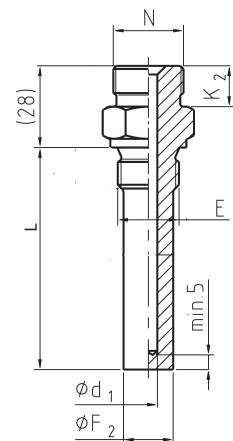

Type	N	E	Ø d1	Ø F1	Ø F2	K2	Immersion length
TW45-G S	Screw	G1/2"	8,2	10	-	12	40, 63 or 100 mm
TW45-G	M18x1,5	G1/2"	8,2	10	-	12	63, 100, 160 or 200 mm
TW50-J	M18x1,5	G1/2"	8,2	-	14	12	40, 50, 63, 100 or 160 mm